

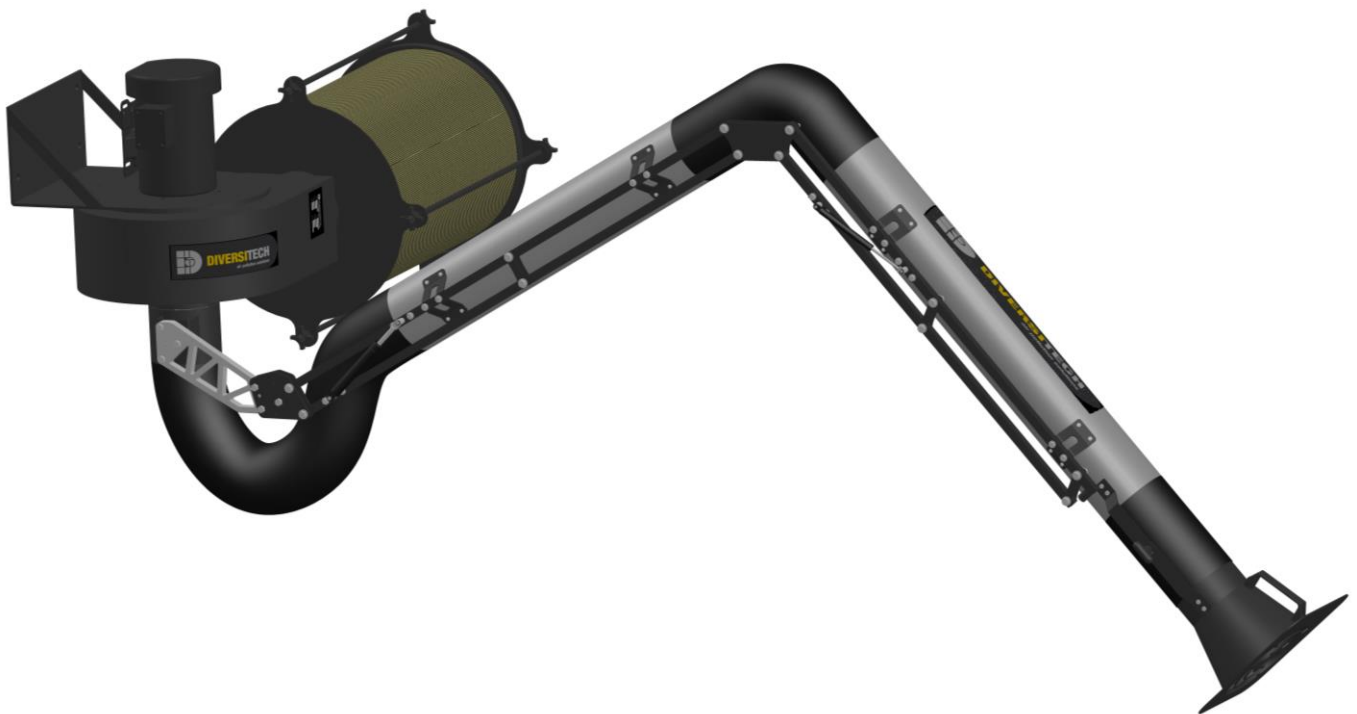

Operation & Maintenance Manual

FRED-ECO



READ AND SAVE THESE INSTRUCTIONS

Visit our Website for more information of this product
www.diversitech.ca

2500 Alphonse Gariépy, Montreal, Quebec H8T 3M2
Tel: 1.800.361.3733 | Fax: 1.514.631.9480 | info@diversitech.ca

Table of Contents

SECTION 1 – SAFETY PRECAUTIONS OF FUME & DUST EXTRACTION/COLLECTION..... 3

1.1 Symbols..... 3

1.2 User Responsibility..... 3

1.3 Fume Extraction Hazards 3

1.4 Dust Collection Hazards..... 4

1.5 Safety Stickers 4

1.6 Sound Levels 4

SECTION 2 – SPECIFICATIONS 5

2.1 Diagram & Description..... 5

2.2 Product Specifications 5

2.3 Dimensions..... 5

2.4 Filter Specifications 5

SECTION 3 – PRE-INSTALLATION 6

3.1 To Setup or Install Safely 6

3.2 Un-Packaging 6

3.3 Tools Required 6

3.4 Mounting Options..... 6

3.5 Electrical Options..... 6

SECTION 4 – ARM-TO-BLOWER DIRECT INSTALLATION 7

4.1 Selecting a Location 7

4.2 Attach Swivel Base to Blower Assembly..... 8

4.3 Attach J-Bracket to Swivel Base..... 8

4.4 Mount Blower Assembly to Attachment Point 9

4.5 Attach Filter to Blower Assembly 10

4.6 Attach Capture Arm to Swivel Base (J-Bracket) 11

4.7 Install Flex Hose 11

SECTION 5 – ARM-TO-BLOWER DIRECT INSTALLATION 12

5.1 Selecting a Location 12

5.2 Attach Swivel Base to Blower Assembly..... 13

5.3 Mount Blower Assembly to Attachment Point 13

5.4 Attach Filter to Blower Assembly 14

5.5 Mount the Remote Mount Bracket in Suitable Location Relative to FRED-ECO Assembly 15

5.6 Install Flex Hose 15

5.7 Attach Swivel Base to Remote Mount Bracket..... 16

5.8 Attach J-Bracket to Arm Swivel..... 16

5.9 Attach Capture Arm to Swivel Base (J-Bracket) 17



5.10 Install Flex Hose 17

SECTION 6 – OPERATION 18





6.1 To Operate Safely 18

6.2 Controls.....	18
6.3 Pre-Use Checklist	18
6.4 Principles of Operation.....	18
6.5 Failure Event	19
SECTION 7 – MAINTENANCE & TROUBLESHOOTING	20
7.1 To Maintain this Product Safely.....	20
7.2 Tools Required.....	20
7.3 Routine Maintenance Schedule	20
7.4 Troubleshooting Procedure	21
7.5 Servicing Filter	22
SECTION 8 – DECOMMISSIONING.....	23
8.1 To Maintain this Product Safely	23
8.2 Tools Required.....	23
8.3 Conformity with Recycling Regulations	23
APPENDIX 1A – ELECTRICAL DIAGRAM [120/220 VAC] Single-Phase Power	24
APPENDIX 1B – ELECTRICAL DIAGRAM [230/460/575v] 3-Phase Power.....	25
APPENDIX 2 – MAINTENANCE RECORD	26
Appendix 3 – MANUFACTURER INFORMATION	27
Appendix 4 – EC DECLARATION OF CONFORMITY	28
Appendix 5 – MACHINE IDENTIFICATION	29
APPENDIX 6 – PARTS LIST.....	30
Appendix 7 – SAMPLE SAFETY STICKERS.....	31
Limited Equipment Warranty	0
Freight Claims	0
Return Material Policy	0

SECTION 1 – SAFETY PRECAUTIONS OF FUME & DUST EXTRACTION/COLLECTION

	READ BEFORE USE	This manual contains specific cautionary statements related to worker safety. To protect yourself and others, read this manual thoroughly and follow as directed before use. Not all hazards of fume & dust control are listed in this manual, and no hazards related to welding, cutting, grinding, painting, deburring or other applications are listed. Consult a qualified safety professional
	DO NOT USE	<p>Do not use this equipment:</p> <ul style="list-style-type: none"> • To extract smoke or fumes above 82°C. • To extract combustible dusts, liquid vapors, aggressive fumes such as acids. • If the power cord has been damaged or ground (third prong) removed. • Without a filter.

1.1 Symbols

This manual uses several symbols to highlight specific hazards. Be familiar with these symbols and when you see them in this manual, read adjoining warning text to avoid the hazard.					
	WARNING! DANGER!	ELECTRIC SHOCK	MOVING PARTS	HOT PARTS	NOISE HAZARD

1.2 User Responsibility

- Improper use can be hazardous.
- All users must carefully read and understand this instruction manual prior to use.
- No objects, such as tools, should be placed on the machine.
- Machine weighs 55 kg without a capture arm attached, proper care should be taken when moving the machine.
- Motor should not contact any objects, and all motor repairs should be performed while the power switch is off and the power source is disconnected. Operator should not touch motor during use.
- Blower assembly should not contact any objects, and all blower repairs should be performed while the power switch is off and the power source is disconnected. Operator should not touch blower during use.
- When walking near machine, or performing maintenance, users should be cautious of hitting head on machine.
- For maintenance of any and all components, power switch must be off and the power source disconnected
- It is your responsibility to follow all applicable ANSI, OSHA, UL, CSA, National & Local Fire Codes, and other regulatory guidelines covering the safe use of equipment that extracts fumes, collects dusts, and exhausts filtered air either indoors or outdoors.
- Before use, inspect the unit for damage and verify it is working properly.
- Only qualified persons should install, operate, maintain, or repair this unit.
- Do not modify or repair the unit with parts or accessories not supplied by the manufacturer.
- Consult filter manufacturer's instructions for filter use and reuse, including instructions for cleaning.

1.3 Fume Extraction Hazards

- Breathing smoke, fumes, or dusts produced in applications such as welding, cutting, grinding, painting, deburring are hazardous to user's health. Proper ventilation or use of well maintained fume extraction and/or dust collection equipment helps the user avoid these hazards.
- Breathable contaminants may not be visible or have an odor.
- Stop operation and leave the area immediately if 1) breathing becomes difficult, 2) experience dizziness, 3) impaired vision, 4) or eye/nose/mouth irritation.

1.4 Dust Collection Hazards

- Dusts from many welding, cutting, grinding, painting, or deburring applications can be combustible.
- Do not use or install equipment where any potential for combustible fumes or dusts are present, until a qualified person has indicated it is safe to do so.
- Never use or install equipment where the potential for combustible fumes or dusts are present without a fire/explosion protection system.
- If you are unsure if the product you purchased is correct for your application, call DiversiTech at 1-800-361-3733.

1.5 Safety Stickers

- This machine is equipped with safety stickers to remind operators of the inherent dangers during use and maintenance.
- The stickers are only reminders, and all safety precautions contained in this manual must be well understood and adhered to by all users.
- See [Appendix 7: Sample Safety Stickers](#) for example of stickers applied to machine.

1.6 Sound Levels



- This machine can emit sound pressure levels in excess of 70dB(A). Sound pressure level of 82 dB(A) was recorded at a height and distance of 1.6m and 1m, respectively, from left of the machine.
- Appropriate ear protection is required when the machine is running.
- Sound levels are highest directly in front of the machine.
- The machine must be turned OFF when performing any maintenance on the machine under any circumstance. Maximum sound pressure levels of 84dB(A) have been recorded at 0m from the machine.
- Extended exposure to sound pressure levels greater than 85dB(A) can cause permanent injury to the ears.
- Users should be conscious of the danger and refrain from placing the ear near the inlet.

SECTION 2 – SPECIFICATIONS

2.1 Diagram & Description

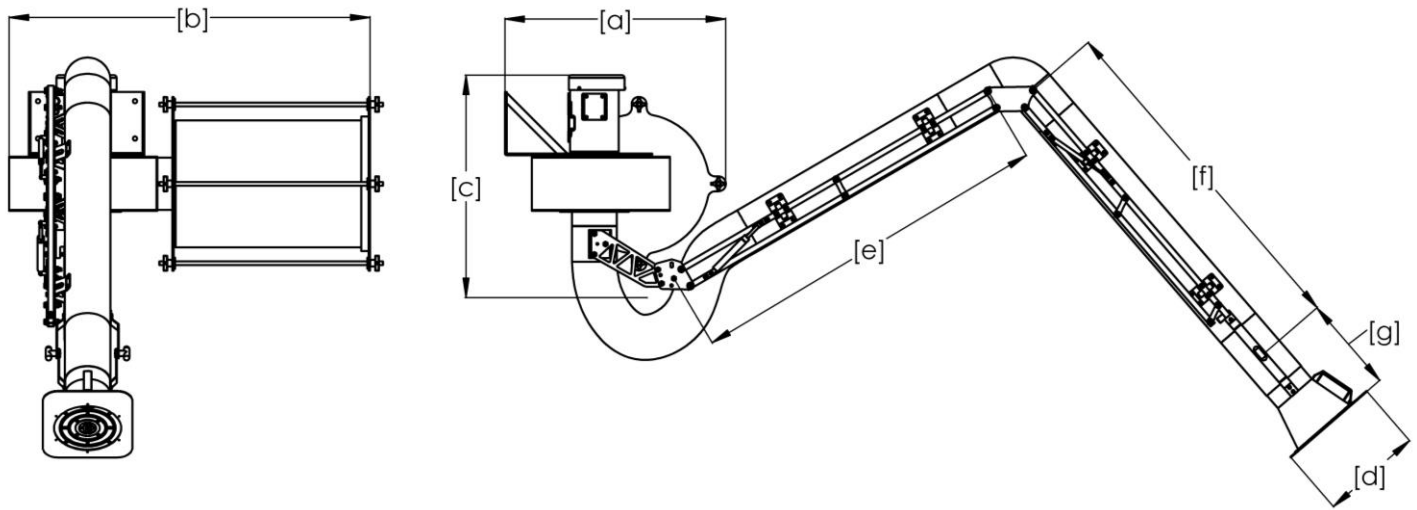

2.2 Product Specifications

Model	Weight w/o Arm (lbs.)	Motor (H.P)	Power					Airflow (CFM)	Cord Length (ft.)	Arm Length (ft.)	
			Phase	@120V (Amps)	@230V (Amps)	@460V (Amps)	@575V (Amps)				
Fume Collector Kits											
FRED-ECO	160	1.5	1P / 60Hz	13.2	---	---	---		1200	15	10/13
	165	3.0	3P / 60Hz	---	7.1	3.7	3.2		1800	---	10/13

2.3 Dimensions

Model	Arm Length (ft.)	Arm Diameter (in.)	Dimensions (in)						
			Width [a]	Length [b]	Height [c]	[d]	[e]	[f]	[g]
Fume Collector Kits									
FRED-ECO	10	6	25+26	27	35	4	5.5	11.5	21
	13	6	25+26	27	35	4	5.5	11.5	21

2.4 Filter Specifications

Part #	Description	Filter Area (SQ.FT)	Filter Efficiency
Primary Filters			
S-ECO2-0001	Paper-Pleated Filter	105	Merv 11
S-ECO2-26NF	Nano-Fiber Filter	320	Merv 15

For information on inspecting and cleaning filter, or purchasing replacement filters, contact DiversiTech at 1-800-361-3733.

SECTION 3 – PRE-INSTALLATION

3.1 To Setup or Install Safely



- Do not place unit near flammables or combustible surfaces.
- Refer to [SECTION 2: Specifications](#), to know the electrical requirements of the unit you are installing and ensure adequate input power that is properly sized, rated, and protected.
- This unit must be grounded for safe operation.

3.2 Un-Packaging

1. Immediately upon receiving the unit, carefully examine the carton for damage during transit.
2. Use lift forks or truck to move.
3. Remove packing material.
4. Avoid tipping or inverting during handling.
5. The item serial number, model, and electrical ratings are listed on the nameplate, see [Appendix 5: Machine Identification](#). Record this information in the Maintenance Record provided, or your own preventative maintenance system.

3.3 Tools Required

1. 7/16 Socket or Wrench
2. 9/16 Socket or Wrench
3. Torque Wrench

The tools above are required for unit assembly. Additional tools, not referenced in this document, will be required for mounting the blower to the attachment point. These tools will depend on material the unit is being attached to, and the anchor hardware selected.

3.4 Mounting Options

1. Arm-To-Blower Direct Installation: Follow guidelines in [Section 4: Arm-to-Blower Direct Installation](#)
2. Arm-to-Remote Mounting Kit Installation: Follow guidelines in [Section 5: Arm-to-Wall with Remote Mounting Kit](#)

3.5 Electrical Options

1. Single-Phase Unit: See [APPENDIX 1A: Electrical Diagram \[110/220 VAC\] Single-Phase Power](#) for wiring instructions. Have a certified electrician install unit according to local regulations.
2. 3-Phase Unit: See [APPENDIX 1B: Electrical Diagram \[230/460/575 VAC\] 3-Phase Power](#) for wiring instructions. Have a certified electrician install unit according to local regulations.

SECTION 4 – ARM-TO-BLOWER DIRECT INSTALLATION

4.1 Selecting a Location



- (1) Read and understand SECTION 1: Safety Precautions.
- (2) Mount sufficiently close to an appropriate power source as outlined in [Section 3.5: Electrical Options](#)
- (3) Near the operator, and within the operating range of the unit.
- (4) With an attachment point (column, platform, or wall) that will support the weight and force of the equipment.
- (5) With sufficient minimum clearance to the right of the unit, as outlined below. Minimum clearances shown allow for easy filter servicing and maximum performance.
- (6) Distance from floor is by user preference, but care should be taken to not mount as an overhead hazard to the operator.

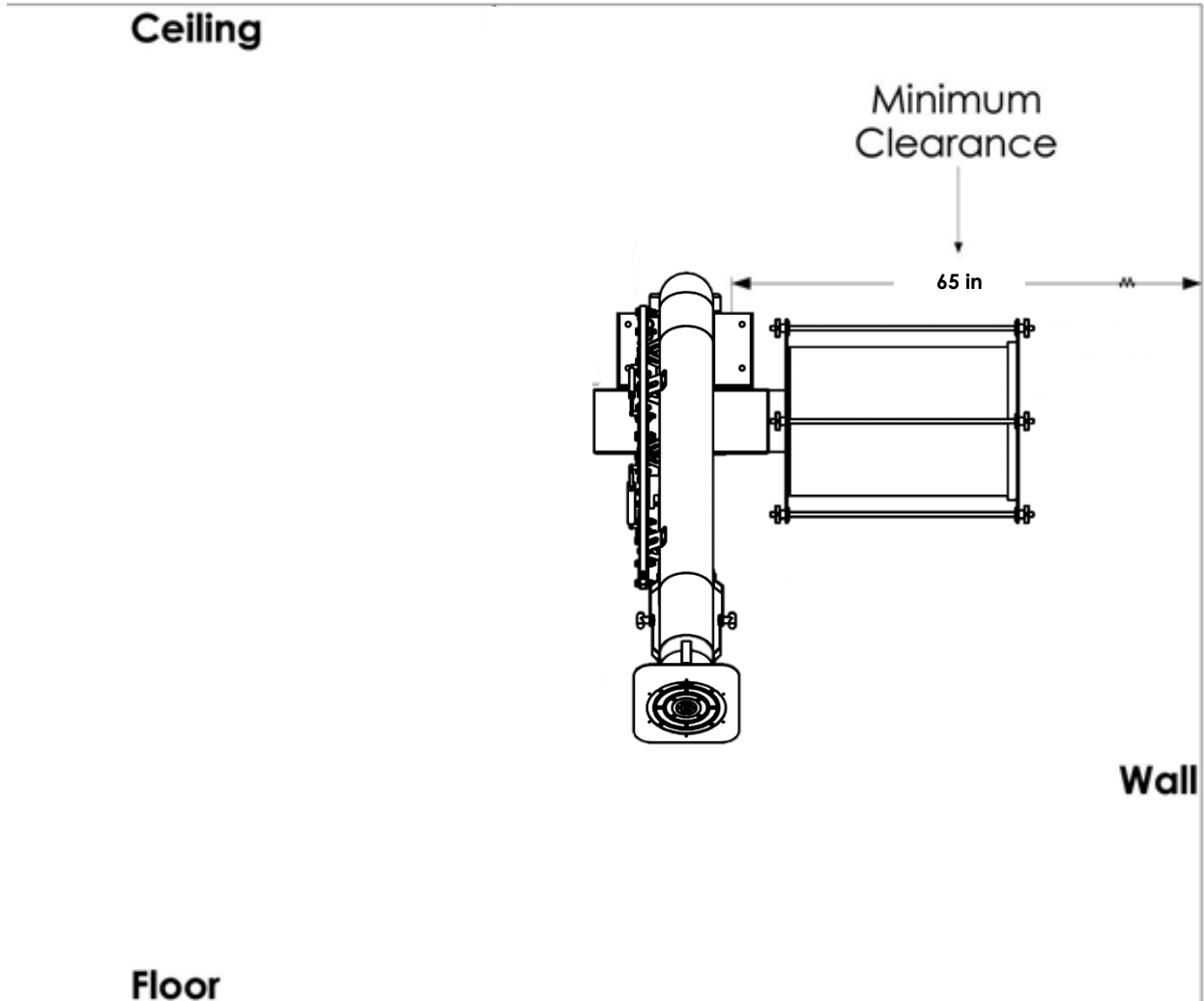

4.2 Attach Swivel Base to Blower Assembly

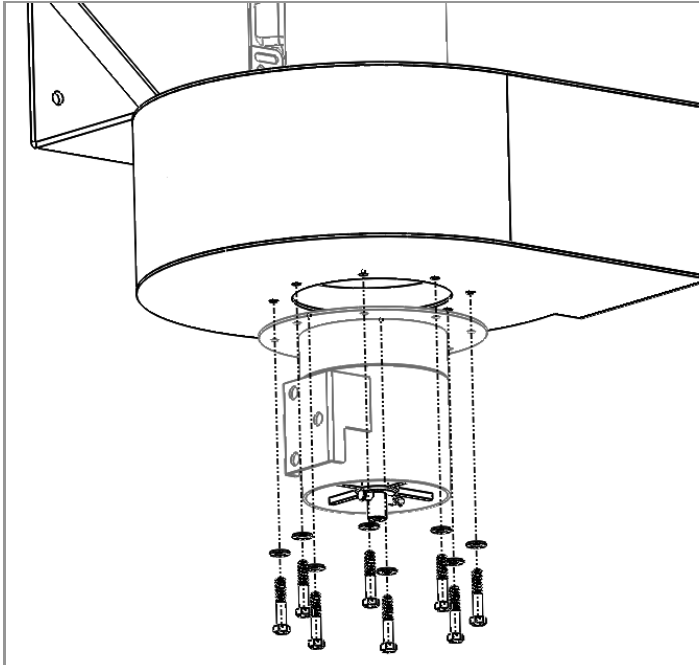

Qty	Description
1	Motor Blower Assembly
1	Swivel Base
8	1/4" Bolt, Socket Cap
8	1/4" Washer

- Mount Swivel Base to Motor Blower Assembly
- Tighten all Bolts (8) with Washers (8)
- Toque each bolt to 23 N m

4.3 Attach J-Bracket to Swivel Base

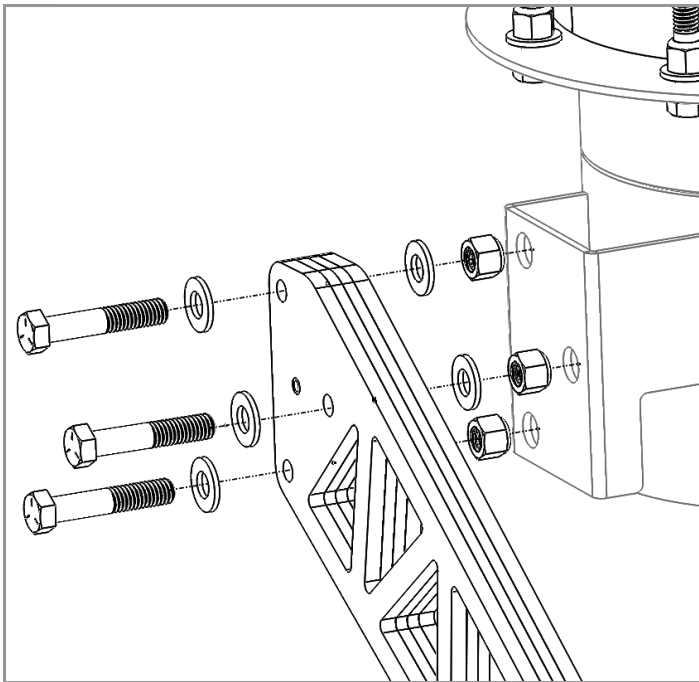

Qty	Description
1	Swivel Base
1	J-Bracket
3	1/4" Bolt, Socket Cap
6	1/4" Washer
3	1/4" Lock Nut, Socket Cap

- Mount J-Bracket to Swivel Base
- Tighten all Bolts (3) with Washers (6) and Nuts (3)
- Toque each bolt to 34 N m

4.4 Mount Blower Assembly to Attachment Point

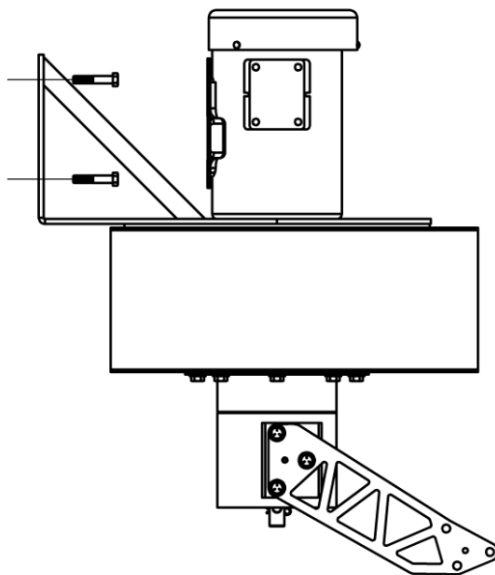

Qty	Description
1	Motor Blower Assembly
NA	Attachment Point Anchors (Not Included)

4.5 Attach Filter to Blower Assembly

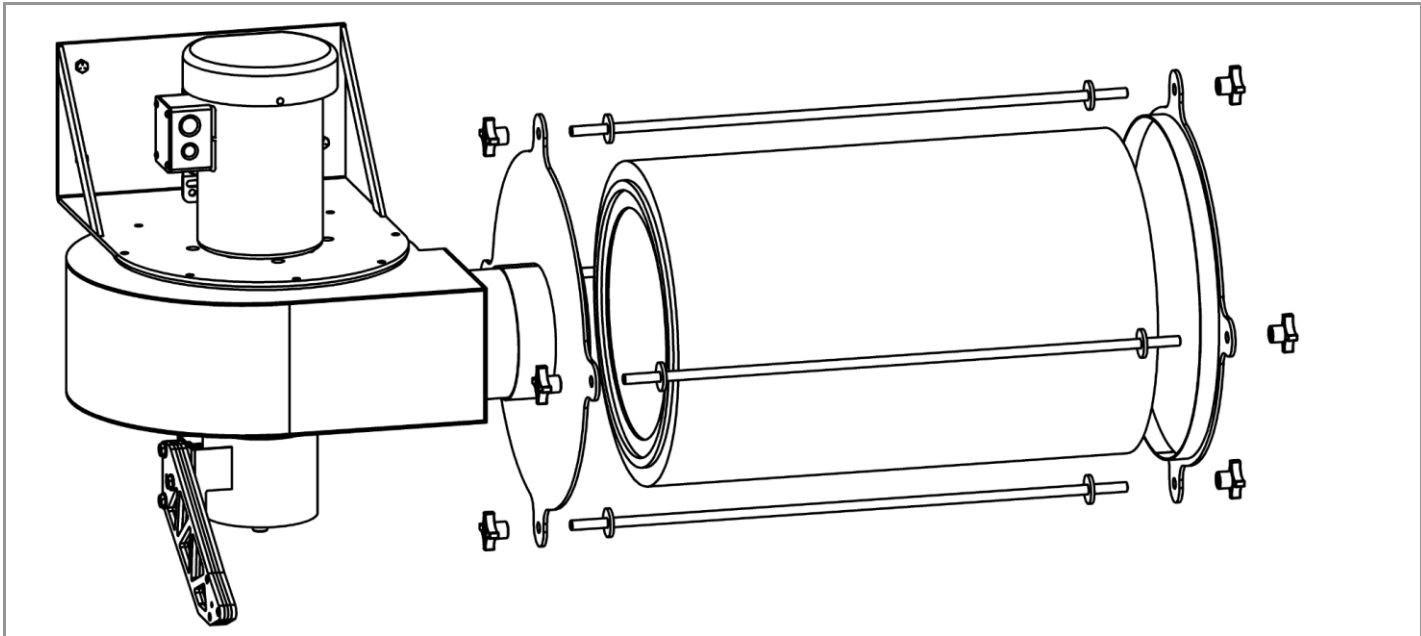

- Place Filter in final location
- Install the Connecting Rods, ensuring the Filter is not damaged during installation
- Tighten left Knobs to hold Connecting Rods
- Install Right Filter Bracket
- Tighten right Knobs to Lock Filter

Qty	Description
1	Motor Blower Assembly
4	3/8" Threaded Rod, 91 cm Length
8	3/8" Threaded Knob
1	Filter Compression Plate Assembly
1	Filter Cartridge

4.6 Attach Capture Arm to Swivel Base (J-Bracket)

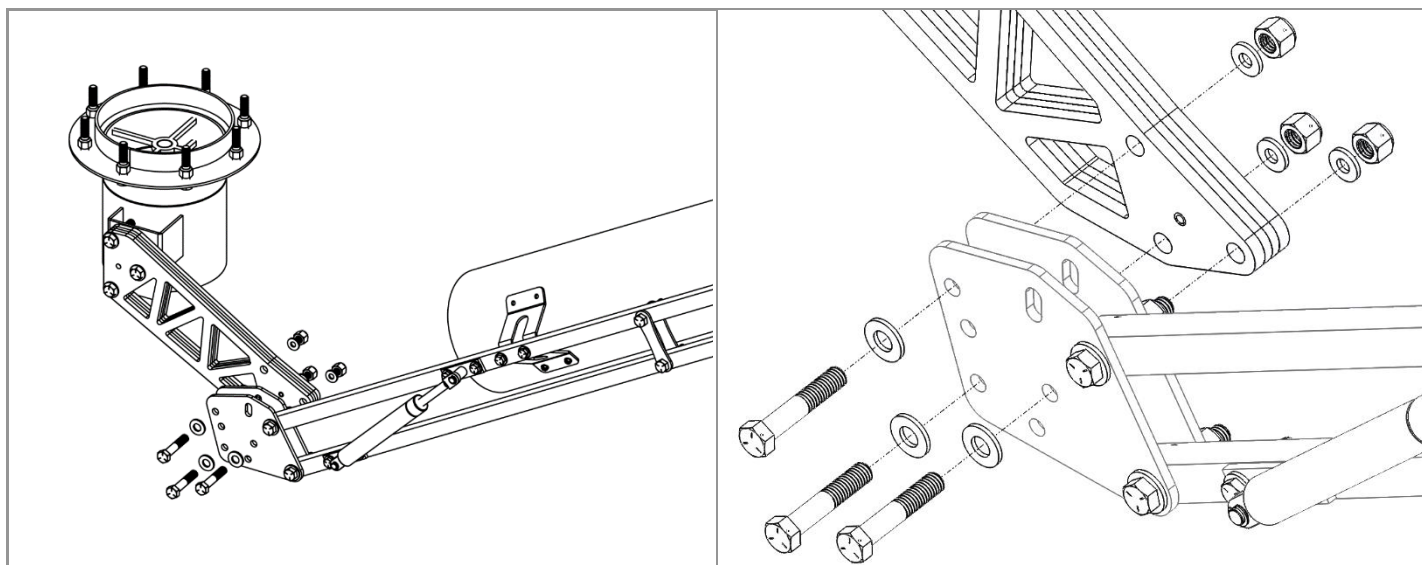

- Insert J-Bracket between Capture Arm Mounting Bracket
- Thread Bolts (3) with Washers (3) through Mounting Bracket and J-Bracket
- Thread Washers (3) and Locking Nuts (3) to Bolts
- Tighten all Bolts (3) to Locking Nuts
- Toque each bolt to 40 N m

Qty	Description
1	Swivel Base with J-Bracket
1	Capture Arm Assembly
3	3/8" Bolt, Socket Cap
6	3/8" Washer
3	3/8" Lock Nut. Socket Cap

4.7 Install Flex Hose

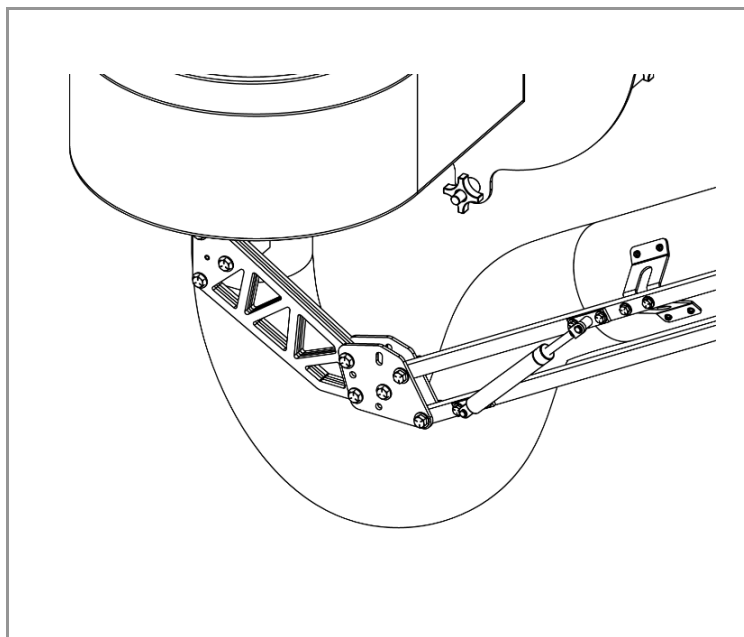

Qty	Description
1	Fred-Eco Assembly
2	Hose Clamps
1	Flex Hose

- Mount Flex Hose to Swivel Base and Capture Arm
- Tighten Both Hose Clamps

SECTION 5 – ARM-TO-BLOWER DIRECT INSTALLATION

5.1 Selecting a Location



- (1) Read and understand SECTION 1: Safety Precautions.
- (2) Mount sufficiently close to an appropriate power source as outlined in [Section 2.5: Electrical Options](#)
- (3) Near the operator, and within the operating range of the unit.
- (4) With an attachment point (column, platform, or wall) that will support the weight and force of the equipment.
- (5) With sufficient minimum clearance to the right of the unit, as outlined below. Minimum clearances shown allow for easy filter servicing and maximum performance.
- (6) Distance from floor is by user preference, but care should be taken to not mount as an overhead hazard to the operator.

Ceiling

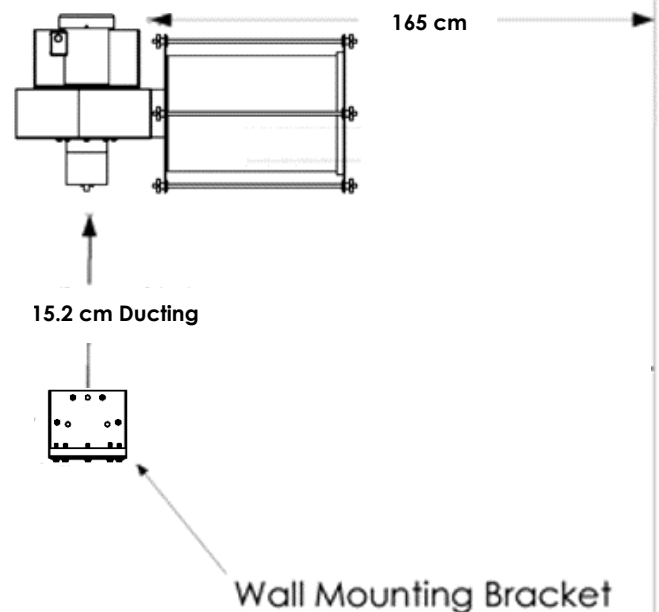

Wall

Floor

5.2 Attach Swivel Base to Blower Assembly

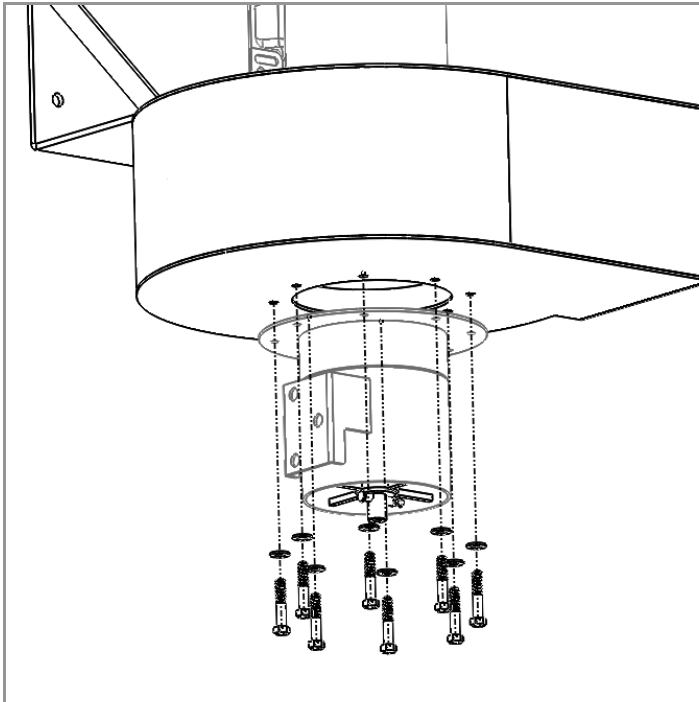

Qty	Description
1	Motor Blower Assembly
1	Swivel Base
8	1/4" Bolt, Socket Cap
8	1/4" Washer

- Mount Swivel Base to Motor Blower Assembly
- Tighten all Bolts (8) with Washers (8)
- Toque each bolt to 23 N m

5.3 Mount Blower Assembly to Attachment Point

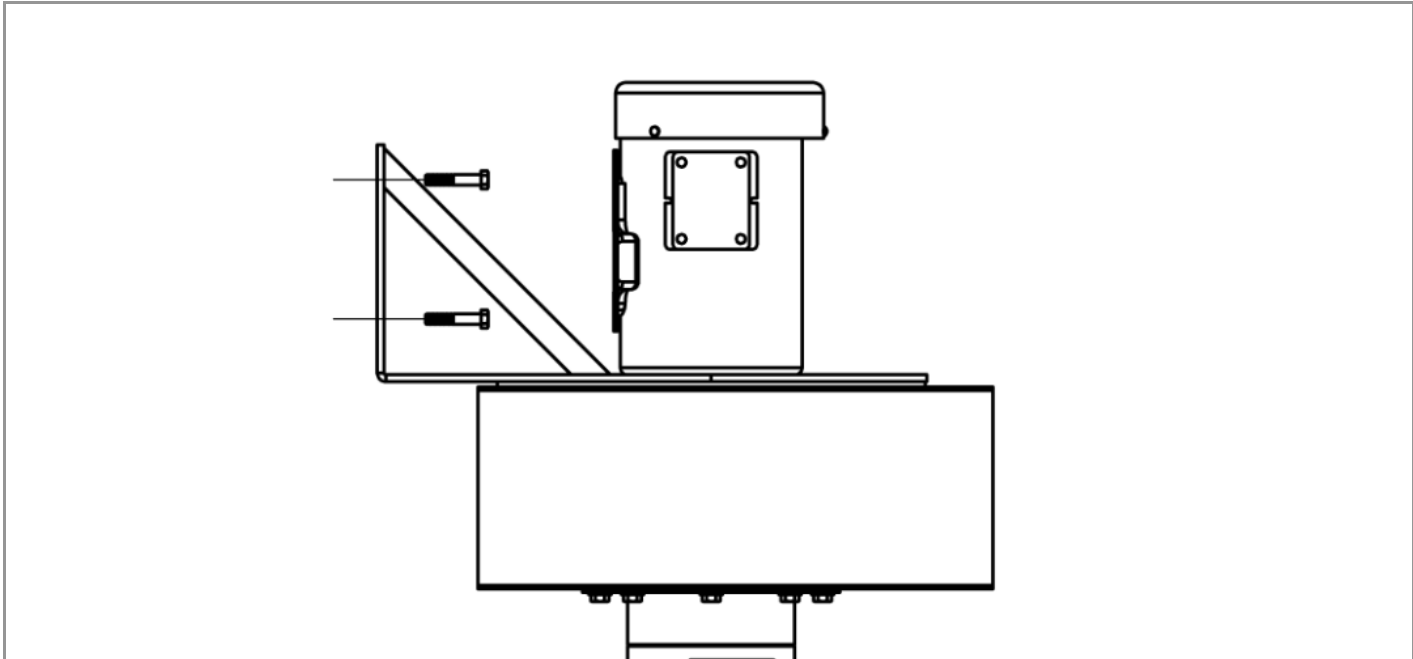

Qty	Description
1	Motor Blower Assembly
NA	Attachment Point Anchors (Not Included)

5.4 Attach Filter to Blower Assembly

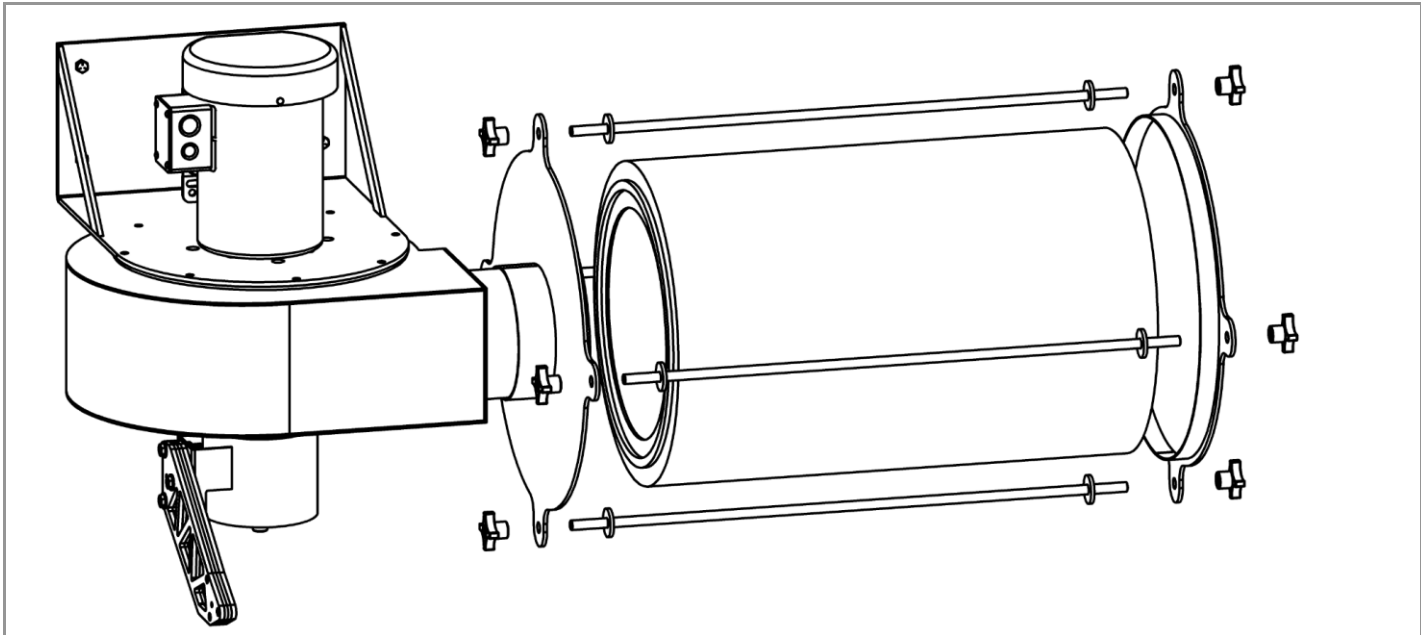

- Place Filter in final location
- Install the Connecting Rods, ensuring the Filter is not damaged during installation
- Tighten left Knobs to hold Connecting Rods
- Install Right Filter Bracket
- Tighten right Knobs to Lock Filter

Qty	Description
1	Motor Blower Assembly
4	3/8" Threaded Rod, 91 cm Length
8	3/8" Threaded Knob
1	Filter Compression Plate Assembly
1	Filter Cartridge

5.5 Mount the Remote Mount Bracket in Suitable Location Relative to FRED-ECO Assembly

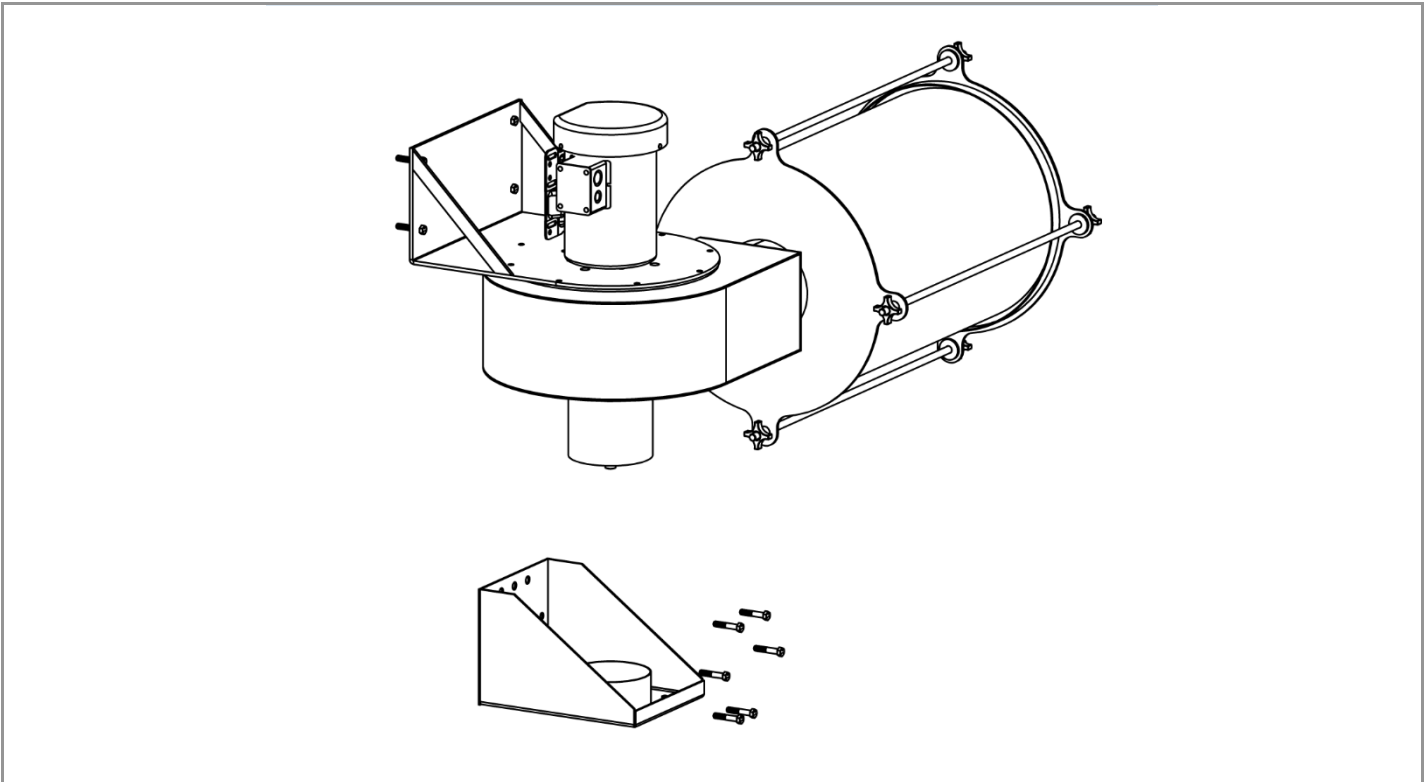

Qty	Description
1	Fred-Eco Assembly
1	Remote Mount Bracket
1	Attachment Point Anchors (Not Included)

5.6 Install Flex Hose

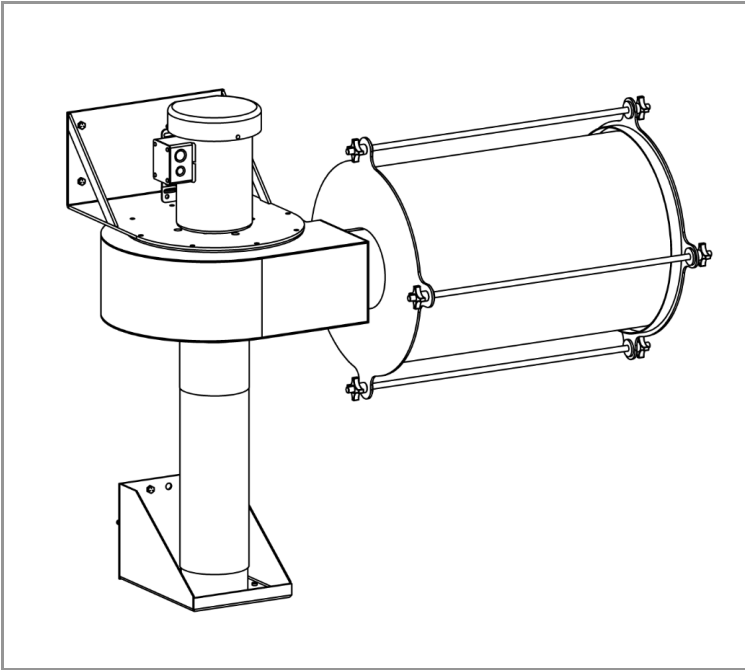

Qty	Description
1	Fred-Eco Assembly
1	Remote Mount Bracket
1	Flex Hose
2	Hose Clamps

- Mount Flex Hose to Swivel Base and Capture Arm
- Tighten Both Hose Clamps

5.7 Attach Swivel Base to Remote Mount Bracket

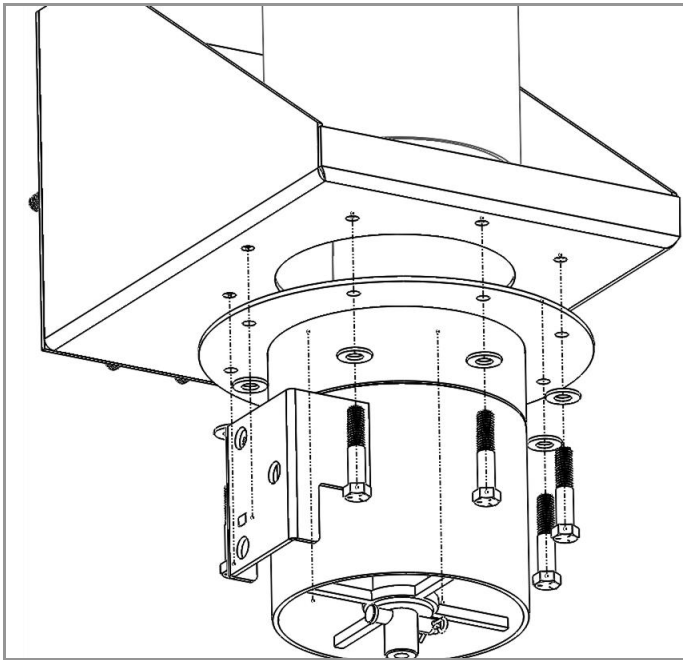

Qty	Description
1	Motor Blower Assembly
1	Swivel Base
8	1/4" Bolt, Socket Cap
8	1/4" Washer

- Mount Swivel Base to Remote Mount Bracket
- Tighten all Bolts (8) with Washers (8)
- Toque each bolt to 23 N m

5.8 Attach J-Bracket to Arm Swivel

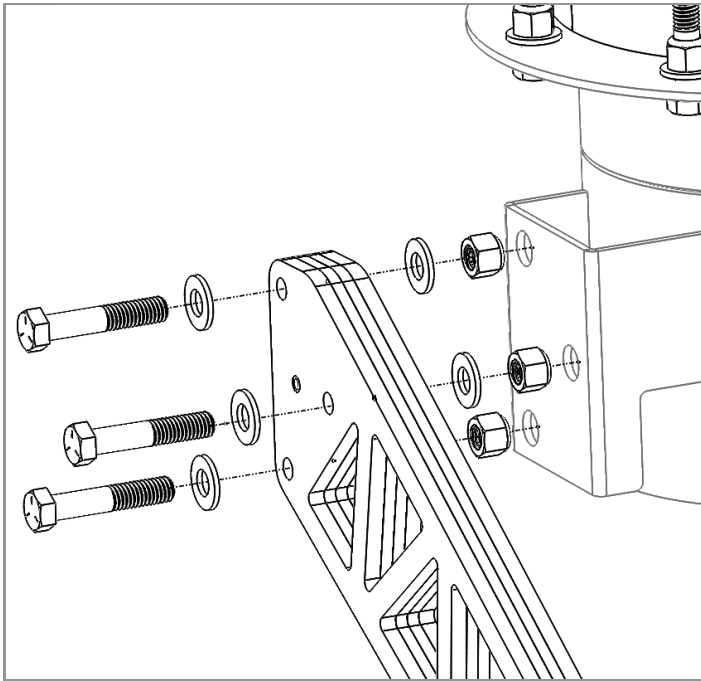

Qty	Description
1	Swivel Base
1	J-Bracket
3	1/4" Bolt, Socket Cap
6	1/4" Washer
3	1/4" Lock Nut, Socket Cap

- Mount J-Bracket to Swivel Base
- Tighten all Bolts (3) with Washers (6) and Nuts (3)
- Toque each bolt to 34 N m

5.9 Attach Capture Arm to Swivel Base (J-Bracket)

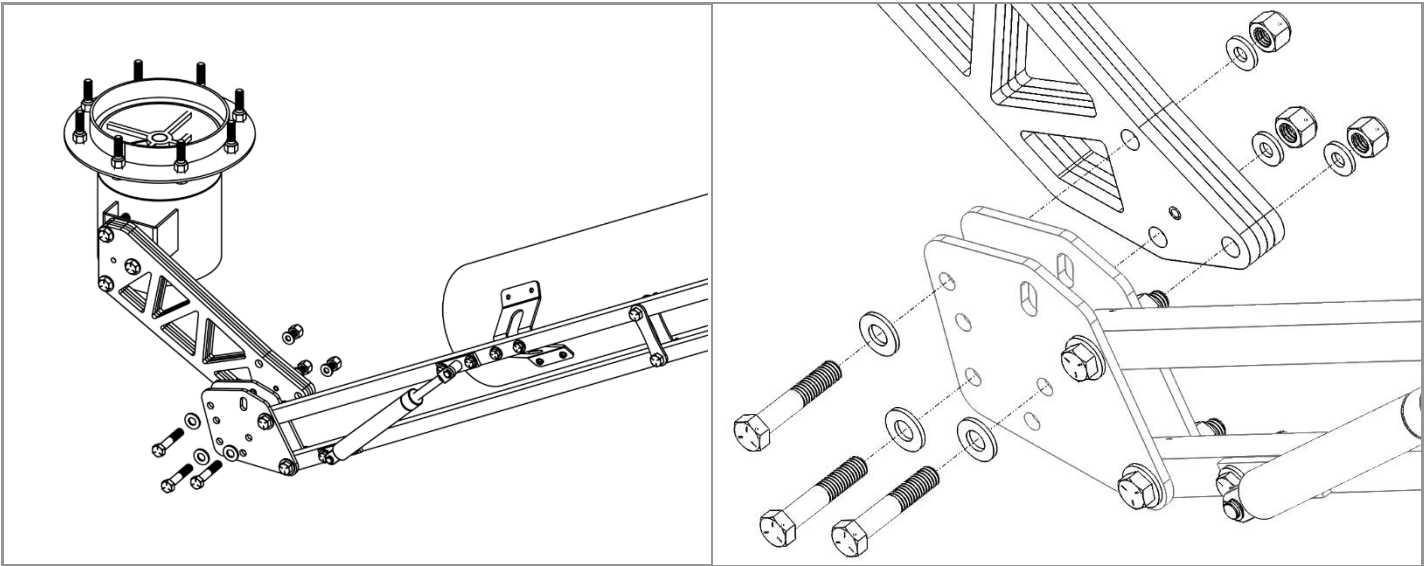

- Insert J-Bracket between Capture Arm Mounting Bracket
- Thread Bolts (3) with Washers (3) through Mounting Bracket and J-Bracket
- Thread Washers (3) and Locking Nuts (3) to Bolts
- Tighten all Bolts (3) to Locking Nuts

Qty	Description
1	Swivel Base with J-Bracket
1	Capture Arm Assembly
3	3/8" Bolt, Socket Cap
6	3/8" Washer
3	3/8" Lock Nut. Socket Cap

5.10 Install Flex Hose

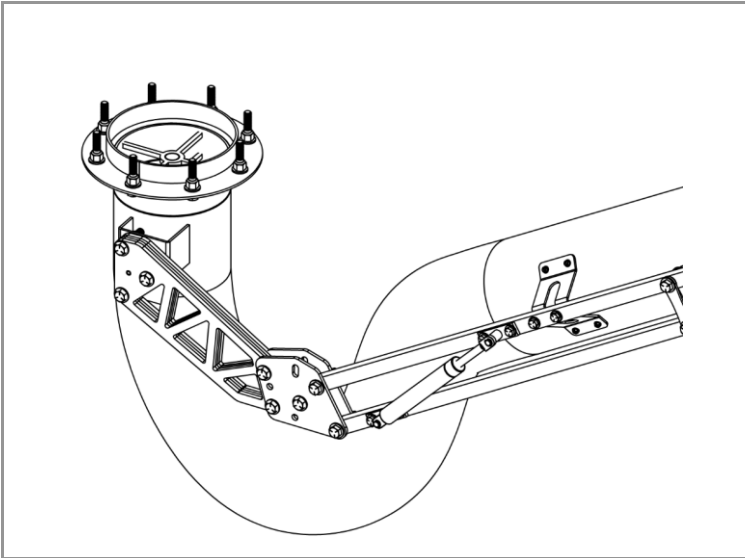

Qty	Description
1	Fred-Eco Assembly
2	Hose Clamps
1	Flex Hose
<ul style="list-style-type: none">• Mount Flex Hose to Swivel Base and Capture Arm• Tighten Both Hose Clamps	

SECTION 6 – OPERATION

6.1 To Operate Safely



- Read and understand [SECTION 1: Safety Precautions](#) and [SECTION 6: Operation](#) before use
- Read and understand all Material Safety Data Sheets and Manufacturer's instructions of all process materials, consumables, and equipment used in conjunction with this equipment.
- Keep away from all mechanical moving parts including motor, gears, and other pinch points.
- Do not use product without first confirming if a Spark Arrestor is required and installed for the type of dust, or fumes you are extracting and/or collection. If you are unsure, call a DiversiTech representative at 1-800-361-3733.

6.2 Controls

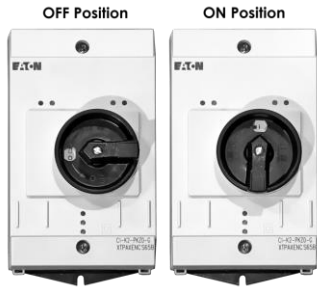

- The machine controls are basic, and consist solely of a power switch with ON and OFF positions.

6.3 Pre-Use Checklist

- Read and understand [SECTION 1: Safety Precautions](#) and ensure [SECTION 3: Pre-Installation](#) has been followed.
- If a capture device has been installed, ensure appropriate sizing and installation practices have been followed.
- Prior to use in your application, turn the unit ON, and perform a function test. To do so:
 1. Turn switch to ON position
 2. LOOK: Is the unit level, stable, and that nothing is obstructing the extraction path.
 3. LISTEN: Does the motor and suction sound smooth and within expected volumes.
 4. FEEL: Place your hand on top of the unit and sense for unexpected vibration. Place your hand in front of the intake hood/surface and sense for expected level(s) of suction.
- Inform all potential users of this equipment where they may find and review this manual.

6.4 Principles of Operation

This product is designed to capture and clean smoke and dust from medium & heavy duty welding, soldering, and grinding applications. When operating, air is drawn in to the nozzle, passes through the 15 cm diameter hose, then through the air cleaner's filtration system, and is exhausted.

This product consists of four basic components:

1. Capture Arm
 2. A blower
 3. Cartridge Filter
 4. Motor & Electrical assemblies
- The operator is to install the machine within operating distance.
 - The operator can then position the capture arm close enough to the worksite to capture all dust and fumes that will be produced.
 - Ensuring that all safety procedures have been followed, the operator can turn on the machine and begin working.
 - When not in use, the machine should be turned off.

6.5 Failure Event

If, for some reason, during operation there is an accident, a blockage occurs, or the machine begins to act abnormally, the operator should immediately shut off the machine. This is considered a machine failure and the following steps should be taken:

1. Turn the power switch to the OFF position.
2. Seek medical attention if an accident occurred.
3. Follow the guidelines in Section 7: Maintenance and Troubleshooting.

Remember, under no circumstance should the machine be turned back on while performing maintenance.





SECTION 7 – MAINTENANCE & TROUBLESHOOTING

7.1 To Maintain this Product Safely



- Read and understand SECTION 1: Safety Precautions and SECTION 6: Operation before maintenance.
- Do not breathe the dust collected from product while changing/cleaning filters or performing maintenance on this product.
- Disconnect power before performing any maintenance on unit, including filter inspection. The input power to this unit is high voltage, and touching any live electrical parts can cause fatal shocks or severe burns. Do not touch live electrical parts.
- Keep away from all mechanical moving parts including motor, gears, and other pinch points while operating.
- Operating this unit causes some parts to heat to a point that will burn bare hands. Before maintenance allow parts to cool, or use proper tools and personal protection equipment during maintenance.
- Machine must be turned off when performing any maintenance.
- Appropriate ear protection is required according to jurisdiction.

7.2 Tools Required

				
EYE PROTECTION	RESPIRATOR	GLOVES	WASTE CONTAINER	REPLACEMENT FILTER (if required)

7.3 Routine Maintenance Schedule

The manufacturer recommends the following routine maintenance based on light-duty use in normal operating conditions. Service more frequently if the unit is used severe conditions.

Frequency	Manual Reference
Pre-Use	
<ul style="list-style-type: none"> • Perform pre-use inspection to ensure operating correctly. 	6.3
As Required – Replace Filter	
1. Replace Filter	7.5
Every (12) months Inspect Basic Components	
<ol style="list-style-type: none"> 1. Clean unreadable labels and exterior surfaces 2. Capture Arm: Check for tears in flex hoses and fitting of hose clamps 3. Cabinet: Look for loose wiring. 	

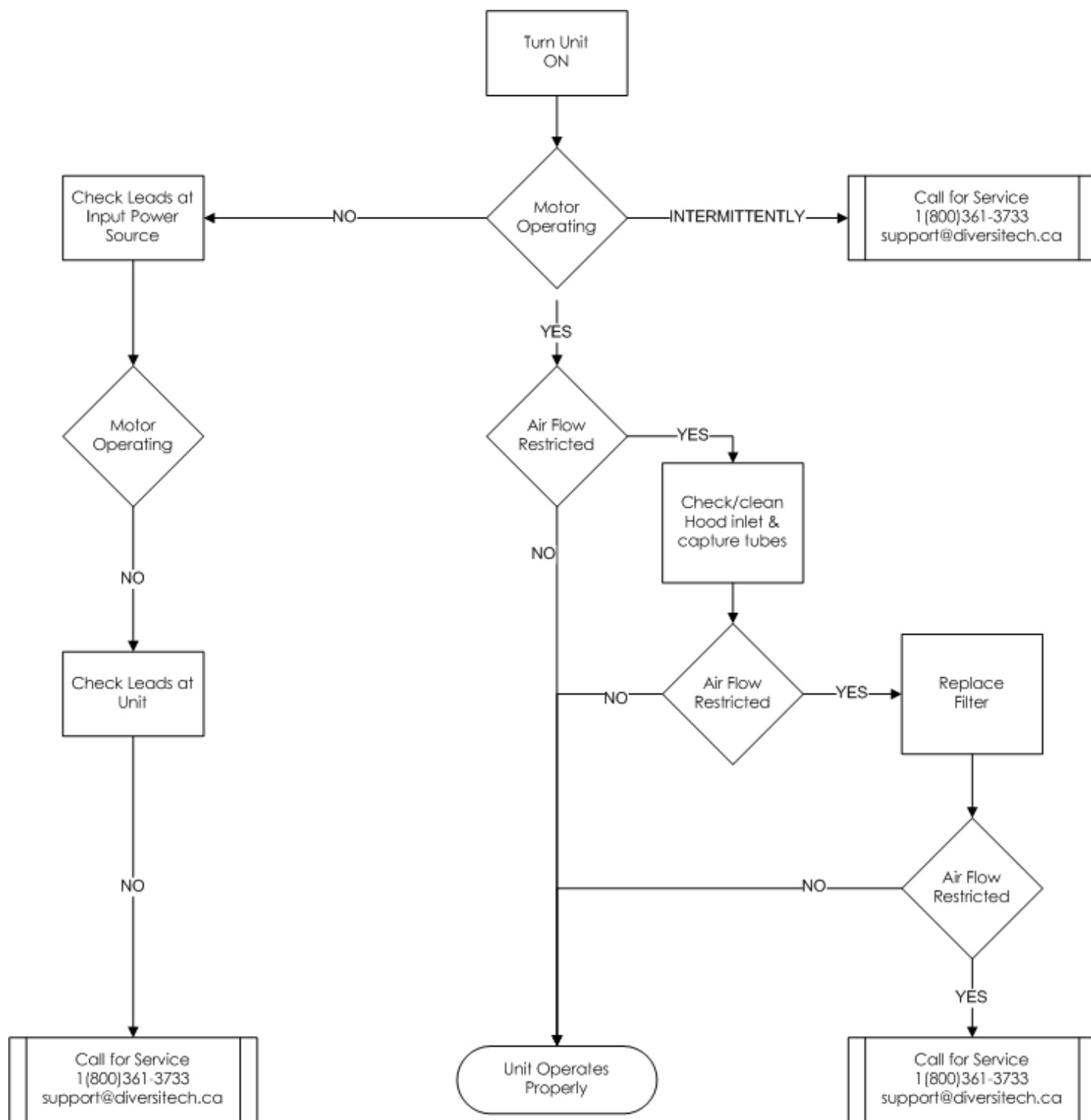

7.5 Servicing Filter



1. Review Maintenance Safety in Section 5.1
2. Turn off power and disconnect input power cord.
3. All components should be supported to avoid falling damage or injury to operator.
4. Support the filter bracket while unbolting the knobs from the connecting rods.
5. Remove the filter bracket.
6. Remove the connecting rods to ensure the filter is not damaged during removal.
7. Remove filter gently so as to minimize agitating dirt and dust, and place it in a bag/container.
8. Clean filter:
 - Use clean/dry air only at a pressure not more than 550 kPa at 30 cm from media.
 - Direct the compressed air through the filter from the clean side, running the nozzle up and down the filter pleats.
 - Do not bring the nozzle in contact with the filter media as damage is likely to occur.
9. Inspect filter for any damage and replace if necessary.
10. If necessary, clean filter brackets of dirt and debris.
11. Reassemble:
 - Install the clean filter
 - Install the connecting rods, ensuring the filter is not damaged during installation.
 - Install the filter bracket.
 - Install the Knobs on the connecting rods with sufficient tightness.

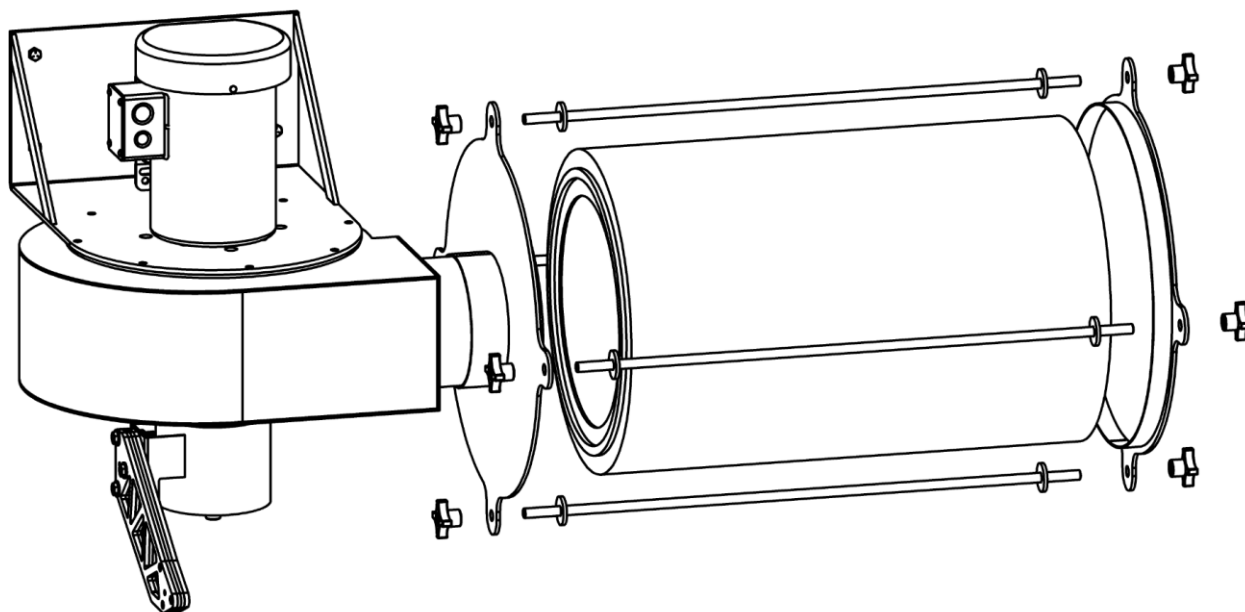

- Place Filter in final location
- Install the Connecting Rods, ensuring the Filter is not damaged during installation
- Tighten left Knobs to hold Connecting Rods
- Install Right Filter Bracket
- Tighten right Knobs to Lock Filter

Qty	Description
1	Motor Blower Assembly
4	3/8" Threaded Rod, 91 cm Length
8	3/8" Threaded Knob
1	Filter Compression Plate Assembly
1	Filter Cartridge

SECTION 8 – DECOMMISSIONING

8.1 To Maintain this Product Safely



- Read and understand SECTION 1: Safety Precautions and SECTION 6: Operation before maintenance.



- Do not breathe the dust collected from product while changing/cleaning filters or performing maintenance on this product.



- Disconnect power before performing any maintenance on unit, including filter inspection. The input power to this unit is high voltage, and touching any live electrical parts can cause fatal shocks or severe burns. Do not touch live electrical parts.
- Keep away from all mechanical moving parts including motor, gears, and other pinch points while operating.



- Operating this unit causes some parts to heat to a point that will burn bare hands. Before maintenance allow parts to cool, or use proper tools and personal protection equipment during maintenance.



- Machine must be turned off when performing any maintenance.
- Appropriate ear protection is required.

8.2 Tools Required

1. 7/16 Socket or Wrench
2. 9/16 Socket or Wrench

The tools above are required for unit dismantling and unmounting the swivel base to the attachment point.

8.3 Conformity with Recycling Regulations

- All dismantling procedures should be made in compliance with appropriate laws governing the recycling and disposal of materials.
- This machine may contain, but is not limited to:
 1. Steel
 2. Plastic
 3. Rubber
 4. Electrical Conductors
 5. Aluminum
 6. Paint
 7. Magnetic Material
 8. Nano-Fiber Filter
 9. Dust and Debris from use

APPENDIX 1A – ELECTRICAL DIAGRAM [110/220 VAC] Single-Phase Power



ELECTRIC SHOCK HAZARD

Disconnect power before performing any maintenance on unit, including filter inspection. The input power to this unit is high voltage, and touching any live electrical parts can cause fatal shocks or severe burns. Do not touch live electrical parts.

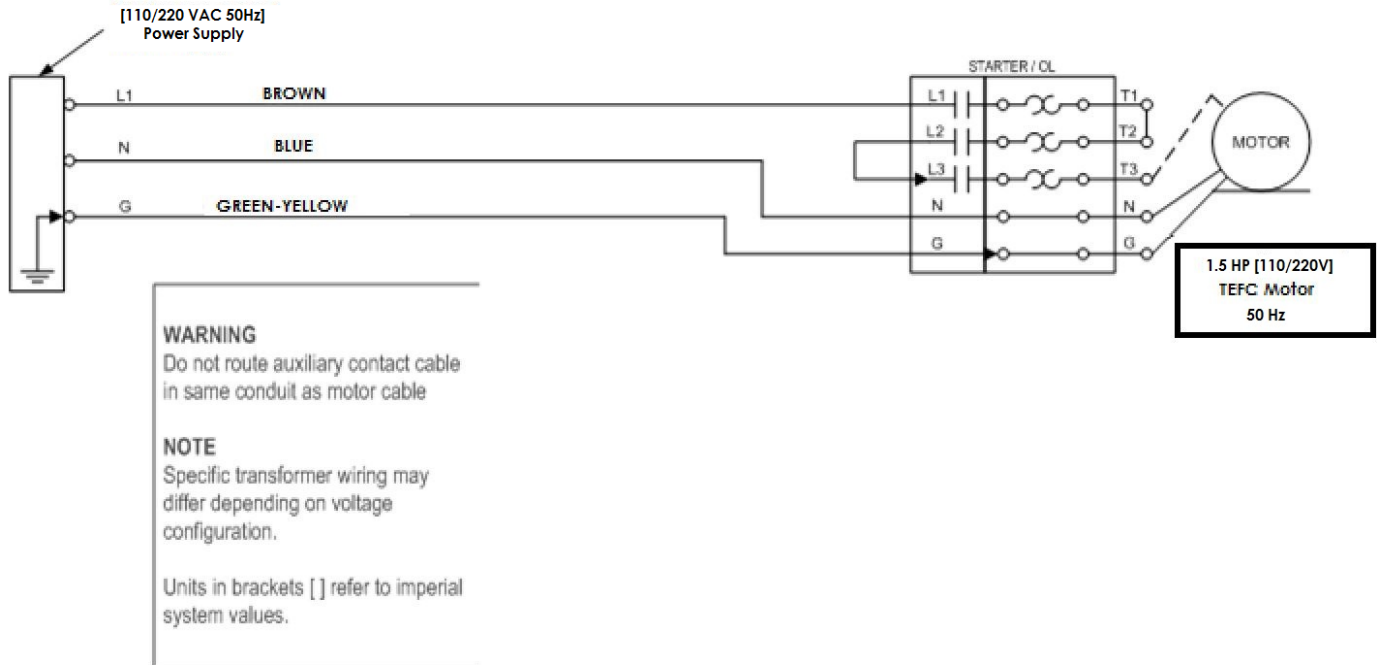

APPENDIX 1B – ELECTRICAL DIAGRAM [230/460/575v] 3-Phase Power



ELECTRIC SHOCK HAZARD

Disconnect power before performing any maintenance on unit, including filter inspection. The input power to this unit is high voltage, and touching any live electrical parts can cause fatal shocks or severe burns. Do not touch live electrical parts.

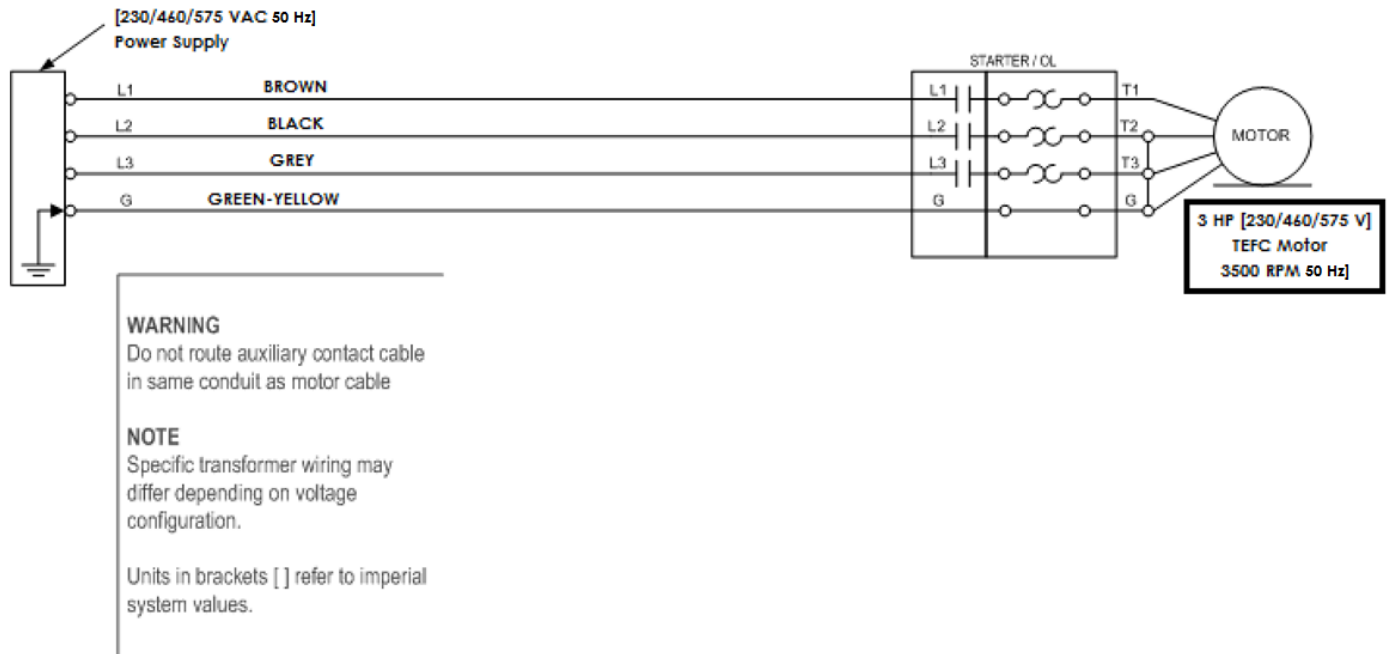

APPENDIX 2 – MAINTENANCE RECORD

DiversiTech Inc. authorizes this page to be photocopied or otherwise reproduced as needed for management of maintenance records.

MANUFACTURER:	DIVERSITECH INC.	MODEL NO:	FRED-ECO	SERIAL NO:	
SERVICE LOCATION:				CONTROL NO:	

Date	Description of Service	Serviced By	Location	Comments

Only use manufacturer approved replacement parts on this unit.

Appendix 3 – MANUFACTURER INFORMATION

Manufactured by: **DIVERSITECH**

Head Office / Manufacturing: **2500 Alphonse Gariépy**
Montreal, Quebec H8T 3M2

Contact Information: **Toll Free: +1 514 855 976 5190**
Direct: +1 514 631-7300
Fax: +1 514 631-9480
Email: info@diversitech.ca

Appendix 4 – EC DECLARATION OF CONFORMITY

(Annex IIA DIR. 2006/42/CE)

THE MANUFACTURER

DIVERSITECH

Company

2500 ALPHONSE GARIEPY

Address

H8T 3M2

Postal Code

QUEBEC

Province

MONTREAL

City

CANADA

Country

DECLARES THAT THE MACHINE

Remote Air Filtration System

Description

FRED-ECO

Model

2016

Year of manufacture

Serial number

FRED-ECO

Commercial name

Remotely installed machine for the extraction of smoke and dust from medium & heavy duty welding, soldering, and grinding applications. When operating, air is drawn in to the nozzle, and passes through the 15 cm diameter hose, then through the air cleaner's filtration system, and is exhausted.

Intended use

IS IN COMPLIANCE WITH THE FOLLOWING DIRECTIVES

Directive 2006/42/EC of the European Parliament and Council of 17 May 2006 on machinery and amending directive 95/16/EC.

Directive 2004/108/EC of the European Parliament and Council of 15 December 2004 on the approximation of the laws of the member States relating to electromagnetic compatibility.

Directive 2006/95/EC of the European Parliament and Council of 12 December 2006 on the approximation of the laws of Member States relating to electrical equipment designed for use within certain voltage limits.

Reference to harmonised standards:

EN 349:1993+A1:2008; EN 614-1:2006+A1:2009; EN 614-2:2000+A1:2008; EN 842:1996+A1:2008; EN 894-3:2000+A1:2008; EN 1005-2:2003+A1:2008; EN 1037:1995+A1:2008; EN 1093-1:2008; EN 1093-4:1996+A1:2008; EN 13478:2001+A1:2008; EN ISO 12100:2010; EN ISO 13849-1:2015; EN ISO 13849-2:2012; EN ISO 13850:2015; EN ISO 13875:2008; EN ISO 14123-1:2015; EN ISO 14123-2:2015; EN ISO 14159:2008

AND DECLARES THAT THE TECHNICAL FILE

Has been compiled by the manufacturer and is kept at:

DiversiTech – 2500 Alphonse Gariepy – Montreal – Quebec – Canada

Appendix 5 – MACHINE IDENTIFICATION

Diversitech machines are identified with an appropriate nameplate that contains:



DIVERSITECH

air pollution solutions

2500 ALPHONSE GARIEPY, MONTREAL, QUEBEC, H8T3M2, TEL: +1 (514) 631 7300

TOLL FREE: +1 (855) 976 5190 FAX: +1 (514) 631 9480 WWW.DIVERSITECH.CA

MOTOR kW	<input type="text"/>	MODEL	<input type="text"/>
VOLTAGE	<input type="text"/>	MAX AMPS	<input type="text"/>
PHASE	<input type="text"/>	HZ	<input type="text"/>
CONTROL VOLTG.	<input type="text"/>	MFG. DATE	<input type="text"/>
SER #	<input type="text"/>		



- Motor kW
- Model
- Voltage
- Max Amps
- Phase
- Hz
- Control Voltage
- Manufacturing Date
- Serial Number



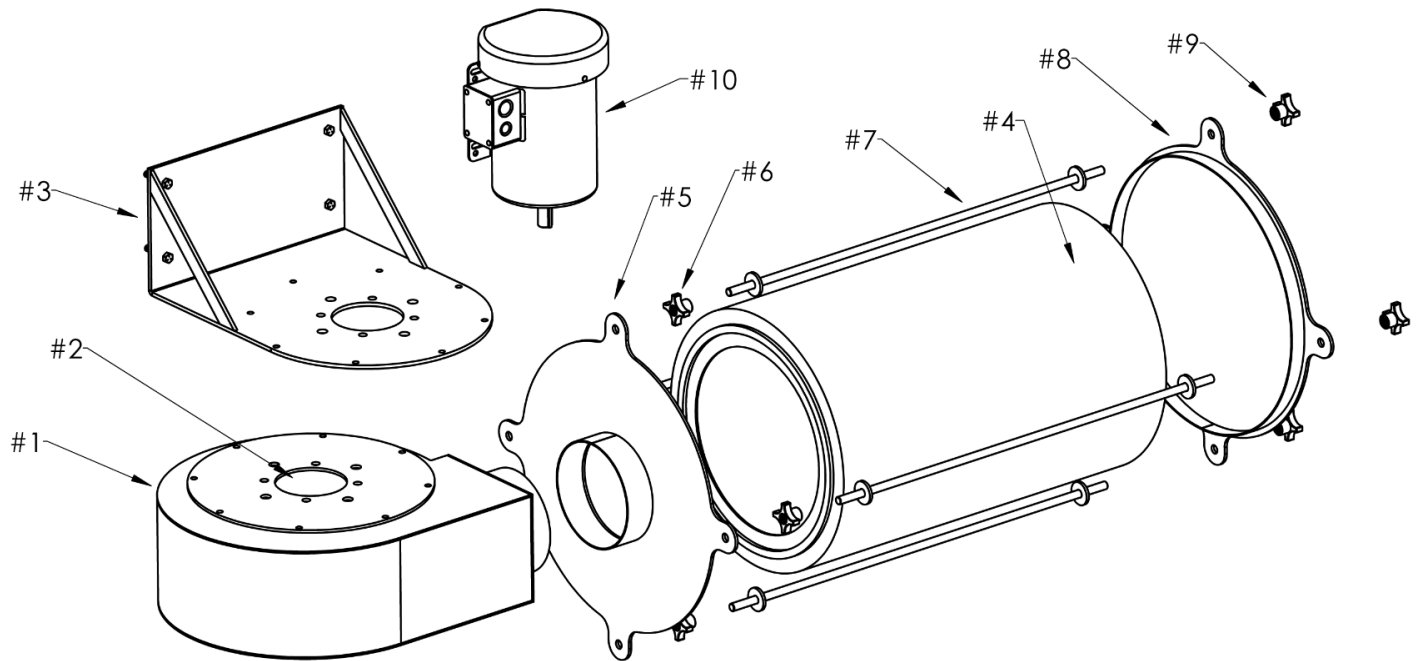

APPENDIX 6 – PARTS LIST







Label No.	Description	Part No.	Qty.
1	Body, Central	BTO-ECO2-06	1
2	Blower Assembly	S-ECO2-1004	standard
3	Body Mounting Bracket	S-ECO2-0007	optional
4	Filter, Nano-Fiber, 99.99% efficient @ 0.5 microns	S-ECO2-26NF	standard
5	Filter Compression Kit, Blower Side Bracket	S-XA-FCB-01	1
6	Filter Compression Kit, Blower Side Knob	S-XA-FCB-02	4
7	Filter Compression Kit, Connecting Rod	S-XA-FCB-04	4
8	Filter Compression Kit, End Bracker	S-XA-FCB-05	1
9	Filter Compression Kit, End Knob	S-XA-FCB-03	4
10	TEFC Motor, 1.5 HP	S-ECO2-015T1	standard

Appendix 7 – SAMPLE SAFETY STICKERS

The machine is marked with a dry filtration safety sticker the operator of safe working practices:

DANGER	AVERTISSEMENT	ADVERTENCIA	DRY FILTRATION
DO NOT USE this equipment:	NE PAS UTILISER cet équipement :	NO USAR este equipo:	
 <ul style="list-style-type: none"> To extract combustible dusts or aggressive fumes such as acids. 	<ul style="list-style-type: none"> Pour l'extraction de poussières combustibles ou de fumées agressives comme les acides 	<ul style="list-style-type: none"> Para extraer polvos inflamables o gases agresivos tales como los ácidos. 	
WARNING	AVERTISSEMENT	ADVERTENCIA	
DO NOT USE this equipment:	NE PAS UTILISER cet équipement :	NO USAR este equipo:	
 <ul style="list-style-type: none"> To extract smoke or fumes above 180°F / 82°C. 	<ul style="list-style-type: none"> Pour l'extraction de fumées ou d'émanations de plus de 82 °C / 180 °F. 	<ul style="list-style-type: none"> Para extraer humo o gases superiores a 180°F / 82°C. 	
 <ul style="list-style-type: none"> If the power cord has been damaged or ground (third prong) removed. 	<ul style="list-style-type: none"> Si le cordon d'alimentation est endommagé ou si la mise à la terre (troisième broche) a été retirée. 	<ul style="list-style-type: none"> Si el cable está dañado o se le ha quitado el tierra (tercera punta). 	
 <ul style="list-style-type: none"> Without a filter 	<ul style="list-style-type: none"> S'il n'y a pas de filtre 	<ul style="list-style-type: none"> Sin filtro 	

The machine is marked with safety stickers in appropriate places to remind the operator of safe working practices.

STICKERS APPLIED TO MACHINE				
Figure 1	Figure 2	Figure 3	Figure 4	Figure 5
Overhead Hazard	Falling Objects Hazard	Moving Parts Hazard	Electric Shock Hazard	Loud Noise Hazard
 CAUTION OVERHEAD HAZARD WATCH YOUR HEAD	 CAUTION FALLING OBJECTS HAZARD DO NOT PLACE OBJECTS ON MACHINE	 CAUTION MOVING PARTS HAZARD DO NOT TOUCH – DISCONNECT POWER BEFORE OPENING	 CAUTION ELECTRIC SHOCK HAZARD SERVICE BY TRAINED PERSONNEL ONLY	 CAUTION LOUD NOISE HAZARD WEAR EAR PROTECTION DURING OPERATION

[illegible]

[illegible]

[illegible]

Limited Equipment Warranty

All DiversiTech units are warranted to be free from defects in material for a period of two years from the date of purchase. DiversiTech Inc. will repair, at our option, any defective parts returned to the manufacturer's plant in Montreal - Quebec freight prepaid- which fail during the warranty period. This warranty is limited to replacement parts ONLY, subject to on site or in house evaluation of defective materials and does not apply to any personal liability or property loss that occurs due to the use or installation of this equipment.

FREIGHT CLAIMS

All DiversiTech units are sold ex-plant, Montreal, Qc., Canada. Therefore, it is the user's responsibility to file any freight claims for obvious or concealed damages which developed in transit from Montreal to your location or when drop shipped.

RETURN MATERIAL POLICY

Prior to the return of material, for whatever reason, a return manufacturing authorization number (RMA#) is required from the DiversiTech production control department. This procedure is necessary for proper control and handling of returned materials. Fax us or call to obtain the RMA.

All material must be returned prepaid. Credit will be given for returns for warranty replacement. Freight collect shipments will not be accepted. It is the shipper's responsibility to insure that material being returned to DiversiTech is adequately packaged for shipment to preclude damages.

Visit our Website for more information of this product

www.diversitech.ca



2500 Alphonse Gariepy
Montreal, Quebec
H8T 3M2

Tel: 1.800.361.3733
Fax: 1.514.631.9480
info@diversitech.ca